



DK-A50Q

DK-A50-Q HAMMER

- ✓ ***QL50 SHANK DESIGN***
- ✓ ***NEW GENERATION***
- ✓ ***SUPERIOR TECHNOLOGY***
- ✓ ***STANDARD BIT DIAMETERS, 5"-5-7/8"***
- ✓ ***DELIVERS MORE ENERGY PER BLOW***
- ✓ ***HARDENED PISTON FOR EXTENDED LIFE***
- ✓ ***INNOVATIVE DESIGN FOR MAXIMUM PERFORMANCE WITH MINIMUM MAINTENANCE***

DRILL KING INTERNATIONAL

820 South Sixth Avenue ♦ Mansfield, TX 76063 ♦ USA

Main#: 817-539-2500 ♦ Fax#: 682-222-1050

Sales#: 817-539-2501 ♦ Toll Free#: 866-900-2487

sales@drillking.net ♦ www.drillking.net

The newest generation of Drill King Hammers means faster penetration, longer life, and less down time due to down hole failures.

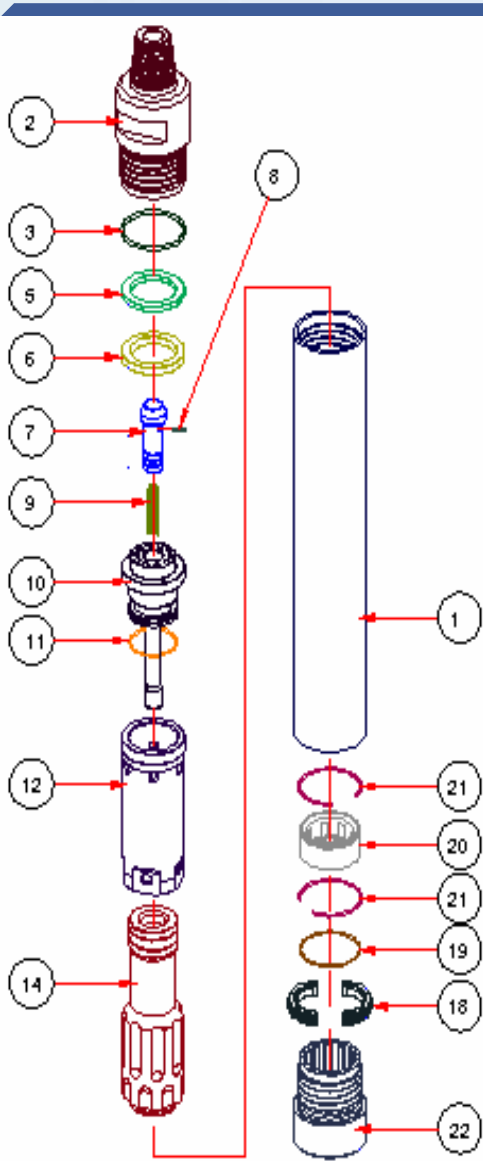

No.	NOMENCLATURE	Qty	Part Number
HAMMER ASSEMBLY (QL50)			HADK-A50Q
1	WEAR SLEEVE	1	HPDK-A5001-Q
2	TOP SUB	1	HPDK-A5002
3	TOP SUB O-RING	1	HPDK-A5003
5	SPRING WASHER	1	HPDK-A5005
6	MAKE UP RING	1	HPDK-A5006
7	CHECK VALVE	1	HPDK-A5007
8	CHOKE SET	1	HPDK-A5008
9	C.V. SPRING	1	HPDK-A5009
10	AIR DISTRIBUTOR	1	HPDK-A5010
11	AIR DIS. O-RING	1	HPDK-A5011
12	CYLINDER	1	HPDK-A5012
14	PISTON	1	HPDK-A5014-Q
18	BIT RET. RING	1	HPDK-A5018-Q
19	BIT RET. RING O-RING	1	HPDK-A5019
20	BIT BEARING	1	HPDK-A5020-Q
21	SNAP RING	2	HPDK-A5021
22	DRIVE SUB	1	HPDK-A5022-Q

Drilling Parameters	
Working Pressure	150-350
Application Bit	5"-5-7/8"
Feed Force (lbs.)	1000-3700

Air Consumption at Different Working Pressures	
150 psi (scfm)	310
250 psi (scfm)	555
350 psi (scfm)	720

Dimensions & Weights	
TOP SUB : 3.5" API PIN	
Tool Length (in)	46.7"
Outside Dia. (in)	4.76"
Stroke (in)	4.00
Weight w/o Bit (lbs)	137
Piston Weight (lbs)	25

Nothing contained in this brochure is intended to extend any warranty or representation for applications expressed or implied, regarding the products described herein. Any such warranties or other terms and conditions of sale of products shall be in accordance with Drill King's standard terms and conditions of sale for such products, which are available upon request.